

Technische Daten Aluminiumprofile Baureihe ISB 40

Strangpressprofile nach DIN EN 12020-1

Legierung	AL Mg Si 0,5 F25
Werkstoff	Nr. 3.3206.72 (warmausgehärtet)

Mechanische Daten (Werte in Pressrichtung)

Zugfestigkeit R _m	min. 240 N/mm ²
Dehngrenze R _p 0,2	min. 190 N/mm ²
Bruchdehnung A ₅	min. 10%
E-Modul	ca. 70.000 N/mm ²
Brinellhärte	ca. 75 HB 2,5/187,5
Längenausdehnungs-Koeffizient	23,8x10 ⁻⁶ /K
Oberfläche nach DIN 17611	E6/EV1-mattgebeizt und naturfarben eloxiert
Schichtdicke	ca. 10µm
Schichthärte	250-350 HV

Sonderfarben auf Anfrage

Lieferlänge 6000mm (oder spezielle Angaben im Katalog)

Profiltoleranzen

Die Maßangaben sind abhängig von der Herstellgenauigkeit der Werkzeuge, vom Werkzeugverschleiß und den Fertigungsschwankungen. Innerhalb einer Fertigungscharge eines Profils liegen die Abweichungen untereinander im 1/100-Bereich



Profiltoleranzen in mm

Meßbereich von - bis	Toleranz ±
0 – 10	± 0,15
10 – 15	± 0,20
15 – 30	± 0,25
30 – 45	± 0,30
45 – 60	± 0,40
60 - 90	± 0,45
90 – 120	± 0,60
120 – 150	± 0,80
150 – 180	± 1,00
180 - 240	± 1,20

Profil 20X20



Artikel Nr.:	019586
Ix	0,72 cm ⁴
Iy	0,72 cm ⁴
Wx	0,72 cm ³
Wy	0,72 cm ³
Profilfläche	1,80 cm ²
Masse	0,48 kg/m

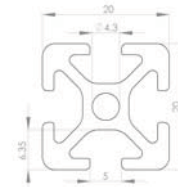

Nut 5

Profil 20X20 2N

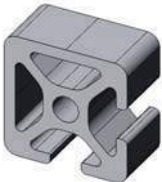

Artikel Nr.:	019595
Ix	0,78 cm ⁴
Iy	0,78 cm ⁴
Wx	0,76 cm ³
Wy	0,76 cm ³
Profilfläche	1,91 cm ²
Masse	0,51 kg/m

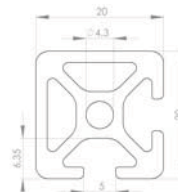

Nut 5

Profil 20X40



Artikel Nr.:	019596
Ix	1,41 cm ⁴
Iy	5,14 cm ⁴
Wx	1,41 cm ³
Wy	2,57 cm ³
Profilfläche	3,32 cm ²
Masse	0,89 kg/m

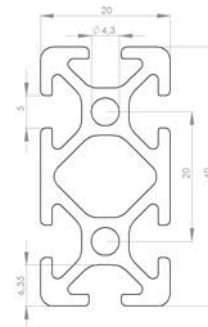

Nut 5

Profil 30X30L

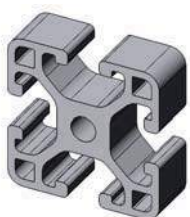

Artikel Nr.:	019597
Ix	2,90 cm ⁴
Iy	2,90 cm ⁴
Wx	1,94 cm ³
Wy	1,94 cm ³
Profilfläche	3,43 cm ²
Masse	0,93 kg/m

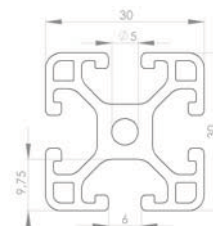

Nut 6

Profil 30X30



Artikel Nr.:	022082
Ix	4,15 cm ⁴
Iy	4,15 cm ⁴
Wx	2,77 cm ³
Wy	2,77 cm ³
Profilfläche	4,67 cm ²
Masse	1,26 kg/m

Nut 6

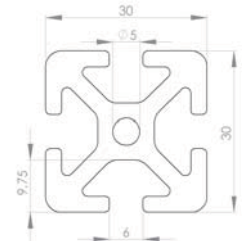

Profil 30X60L



Artikel Nr.:	019598
Ix	5,54 cm ⁴
Iy	21,22 cm ⁴
Wx	3,69 cm ³
Wy	7,07 cm ³
Profilfläche	6,13 cm ²
Masse	1,65 kg/m

Nut 6

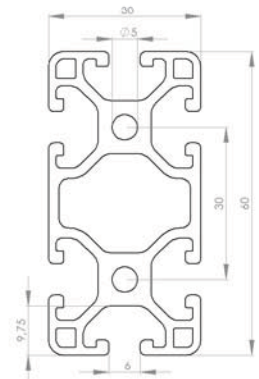

Profil 30X60



Artikel Nr.:	022083
Ix	7,92 cm ⁴
Iy	29,30 cm ⁴
Wx	5,28 cm ³
Wy	9,77 cm ³
Profilfläche	8,47 cm ²
Masse	2,29 kg/m

Nut 6

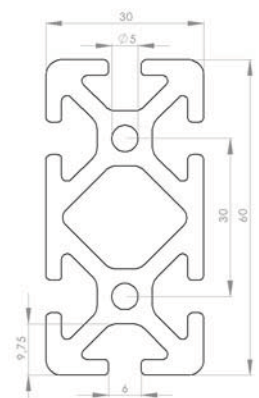

Profil 40X40L 1N

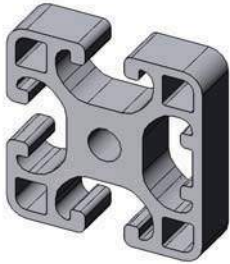

Artikel Nr.:	10414
Ix	9,54 cm ⁴
Iy	9,01 cm ⁴
Wx	4,66 cm ³
Wy	4,50 cm ³
Profilfläche	6,61 cm ²
Masse	1,78 kg/m

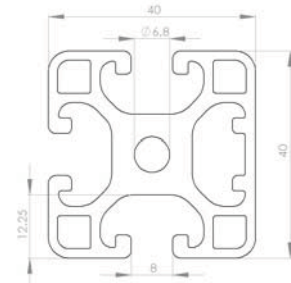

Nut 8

Profil 40X40L 2N180

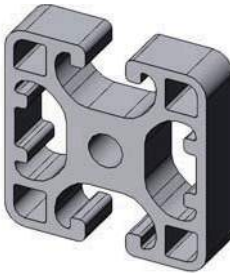

Artikel Nr.:	13451
Ix	9,02 cm ⁴
Iy	10,11 cm ⁴
Wx	4,51 cm ³
Wy	5,05 cm ³
Profilfläche	6,77 cm ²
Masse	1,83 kg/m

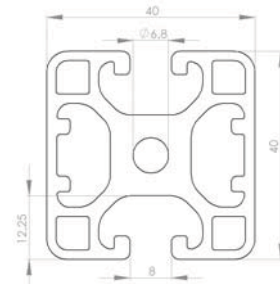

Nut 8

Profil 40X40L 3N

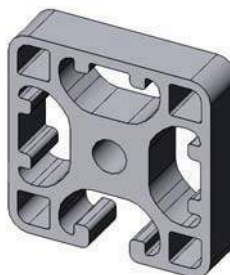

Artikel Nr.:	13450
Ix	9,62 cm ⁴
Iy	10,22 cm ⁴
Wx	4,70 cm ³
Wy	5,11 cm ³
Profilfläche	6,96 cm ²
Masse	1,90 kg/m

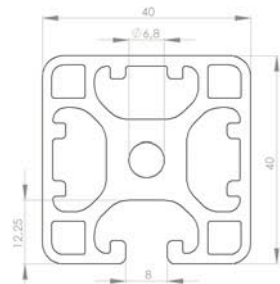

Nut 8

Profil 40X40L 2N90

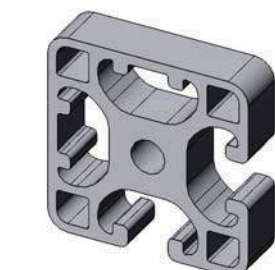

Artikel Nr.:	019602
Ix	9,64 cm ⁴
Iy	9,64 cm ⁴
Wx	4,70 cm ³
Wy	4,70 cm ³
Profilfläche	6,80 cm ²
Masse	1,84 kg/m

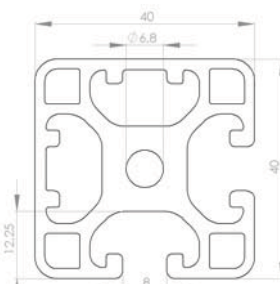

Nut 8

Profil 40X40L



Artikel Nr.:	019600
Ix	9,00 cm ⁴
Iy	9,00 cm ⁴
Wx	4,50 cm ³
Wy	4,50 cm ³
Profilfläche	6,46 cm ²
Masse	1,74 kg/m

Nut 8

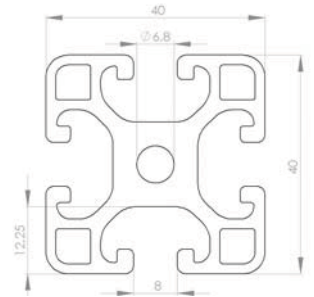

Profil 40X40



Artikel Nr.:	021696
Ix	13,96 cm ⁴
Iy	13,96 cm ⁴
Wx	6,98 cm ³
Wy	6,98 cm ³
Profilfläche	9,16 cm ²
Masse	2,47 kg/m

Nut 8

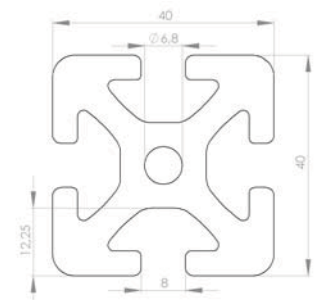

Profil 40X40EL



Artikel Nr.:	019601
Ix	7,38 cm ⁴
Iy	7,38 cm ⁴
Wx	3,69 cm ³
Wy	3,69 cm ³
Profilfläche	5,07 cm ²
Masse	1,37 kg/m

Nut 8

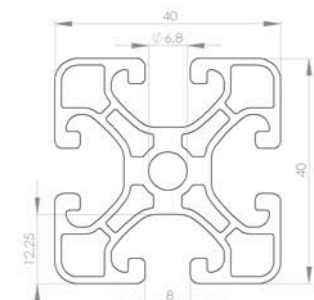

Profil 40X80L



Artikel Nr.:	019603
Ix	16,60 cm ⁴
Iy	69,54 cm ⁴
Wx	8,30 cm ³
Wy	17,38 cm ³
Profilfläche	11,38 cm ²
Masse	3,04 kg/m

Nut 8

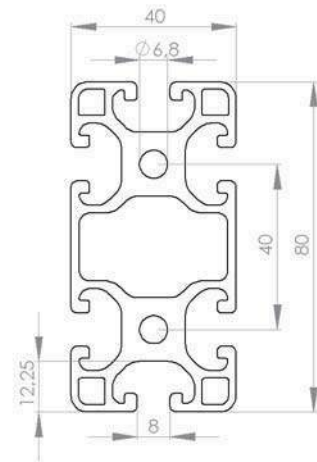

Profil 40X80

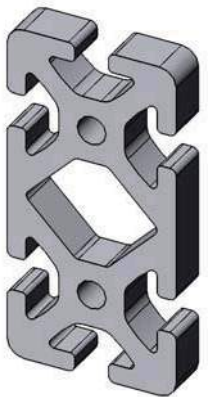

Artikel Nr.:	021960
Ix	26,87 cm ⁴
Iy	101,19 cm ⁴
Wx	13,44 cm ³
Wy	25,29 cm ³
Profilfläche	16,76 cm ²
Masse	4,53 kg/m

Nut 8

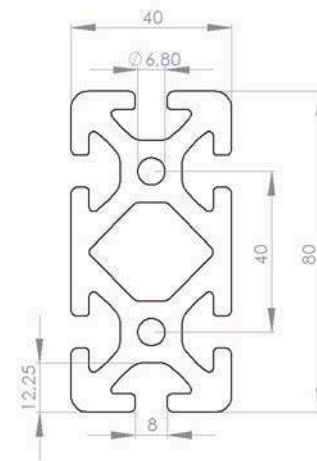

Profil 40X80L 2N

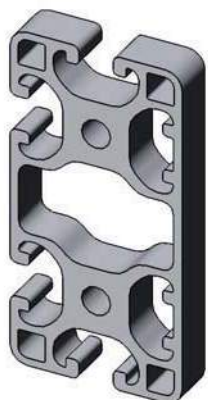

Artikel Nr.:	10415
Ix	17,73 cm ⁴
Iy	70,87 cm ⁴
Wx	8,63 cm ³
Wy	17,72 cm ³
Profilfläche	11,60 cm ²
Masse	3,13 kg/m

Nut 8

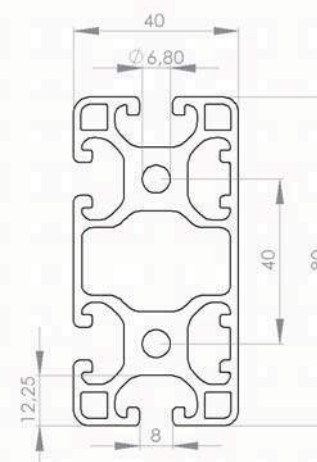

Profil 40X40 45°



Artikel Nr.:	12022
Ix	9,39 cm ⁴
Iy	9,39 cm ⁴
Wx	4,08 cm ³
Wy	4,08 cm ³
Profilfläche	7,30 cm ²
Masse	1,97 kg/m

Nut 8

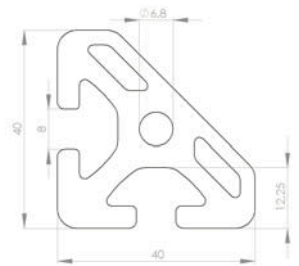

Profil 40X40L R40-90°



Artikel Nr.:	10995
Ix	6,65 cm ⁴
Iy	6,65 cm ⁴
Wx	3,04 cm ³
Wy	3,04 cm ³
Profilfläche	5,72 cm ²
Masse	1,54 kg/m

Nut 8

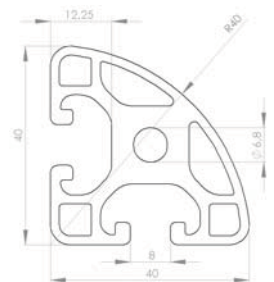

Profil 40X120L



Artikel Nr.:	12013
Ix	24,22 cm ⁴
Iy	220,54 cm ⁴
Wx	12,11 cm ³
Wy	36,76 cm ³
Profilfläche	16,12 cm ²
Masse	4,35 kg/m

Nut 8

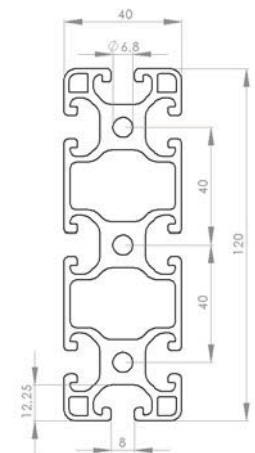

Profil 40X120



Artikel Nr.:	12014
Ix	39,80 cm ⁴
Iy	322,66 cm ⁴
Wx	19,90 cm ³
Wy	53,77 cm ³
Profilfläche	24,38 cm ²
Masse	6,58 kg/m

Nut 8

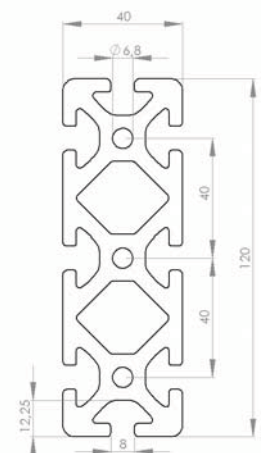

2.9

Profil 40X160L



Artikel Nr.:	022540
Ix	31,81 cm ⁴
Iy	500,32 cm ⁴
Wx	15,90 cm ³
Wy	62,54 cm ³
Profilfläche	20,90 cm ²
Masse	5,64 kg/m

Nut 8

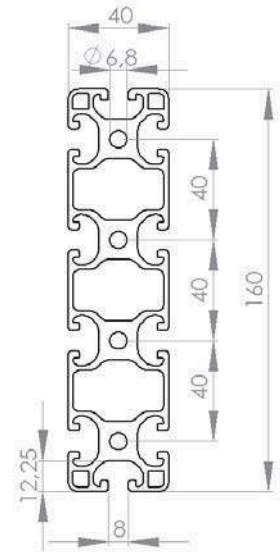

Profil 40X160



Artikel Nr.:	12565
Ix	52,72 cm ⁴
Iy	739,62 cm ⁴
Wx	26,36 cm ³
Wy	92,45 cm ³
Profilfläche	32,00 cm ²
Masse	8,64 kg/m

Nut 8

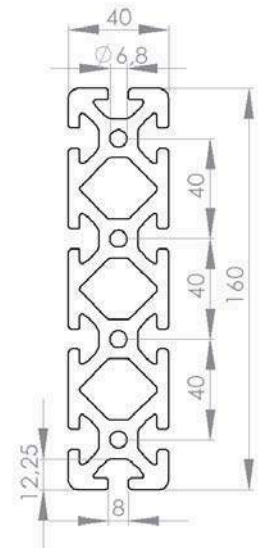

Profil 80X80L

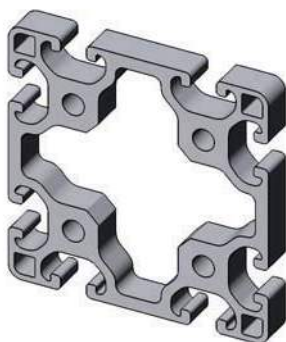

Artikel Nr.:	019605
Ix	134,06 cm ⁴
Iy	134,06 cm ⁴
Wx	33,51 cm ³
Wy	33,51 cm ³
Profilfläche	19,75 cm ²
Masse	5,33 kg/m

Nut 8

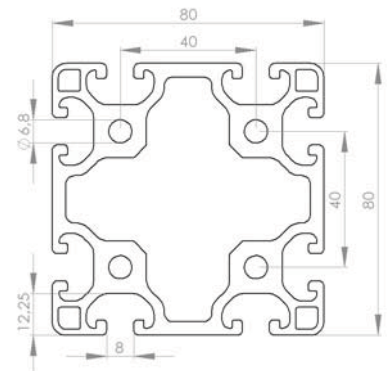

Profil 80X120L



Artikel Nr.:	12015
Ix	201,89 cm ⁴
Iy	421,67 cm ⁴
Wx	50,47 cm ³
Wy	68,34 cm ³
Profilfläche	30,13 cm ²
Masse	8,13 kg/m

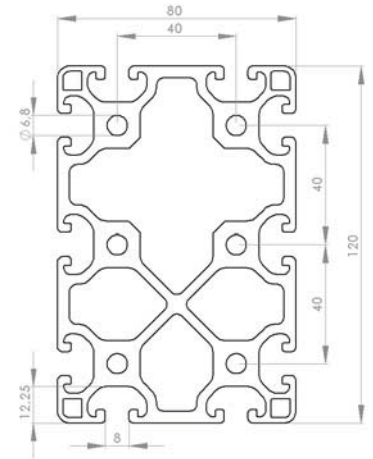

Nut 8

Profil 80X120



Artikel Nr.:	019606
Ix	274,86 cm ⁴
Iy	574,86 cm ⁴
Wx	68,71 cm ³
Wy	92,72 cm ³
Profilfläche	40,05 cm ²
Masse	10,81 kg/m

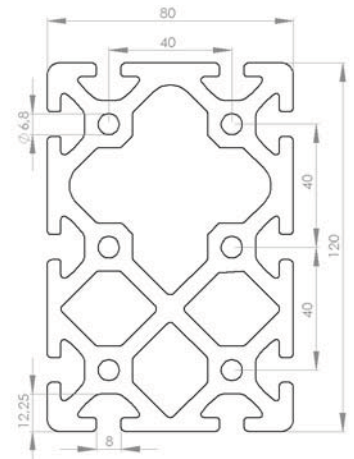

Nut 8

Profil 80X160L



Artikel Nr.:	12016
Ix	267,07 cm ⁴
Iy	907,88 cm ⁴
Wx	66,77 cm ³
Wy	113,48 cm ³
Profilfläche	37,80 cm ²
Masse	10,21 kg/m

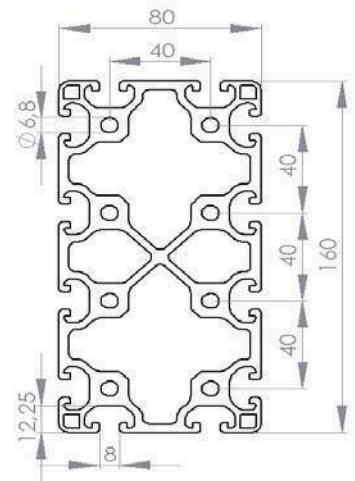

Nut 8

Profil R40/80-30°



Artikel Nr.:	12018
Ix	6,42 cm ⁴
Iy	8,90 cm ⁴
Wx	2,84 cm ³
Wy	3,80 cm ³
Profilfläche	6,20 cm ²
Masse	1,67 kg/m

Nut 8

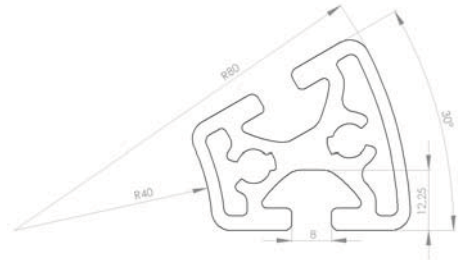

Profil R40/80-45°



Artikel Nr.:	12019
Ix	21,33 cm ⁴
Iy	16,06 cm ⁴
Wx	6,74 cm ³
Wy	6,14 cm ³
Profilfläche	10,23 cm ²
Masse	2,76 kg/m

Nut 8

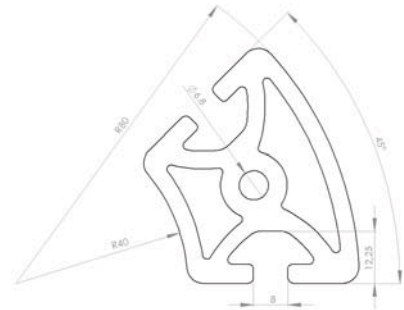

Profil R40/80-60°



Artikel Nr.:	12434
Ix	22,64 cm ⁴
Iy	34,92 cm ⁴
Wx	5,96 cm ³
Wy	11,56 cm ³
Profilfläche	10,50 cm ²
Masse	2,82 kg/m

Nut 8

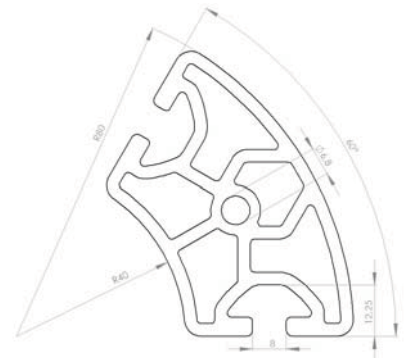

Profil R40/80-90°



Artikel Nr.:	12021
Ix	76,25 cm ⁴
Iy	76,25 cm ⁴
Wx	18,69 cm ³
Wy	18,69 cm ³
Profilfläche	15,00 cm ²
Masse	4,05 kg/m

Nut 8

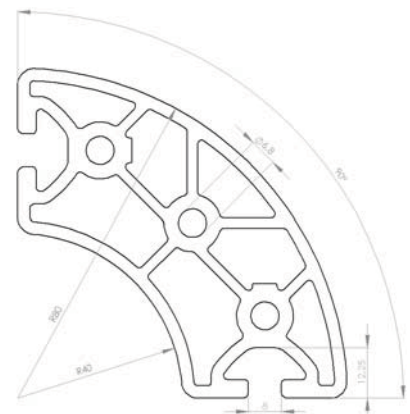

Profil 80X16

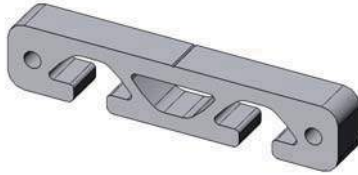

Artikel Nr.:	12012
Ix	2,15 cm ⁴
Iy	50,76 cm ⁴
Wx	2,69 cm ³
Wy	12,69 cm ³
Profilfläche	8,13 cm ²
Masse	2,20 kg/m

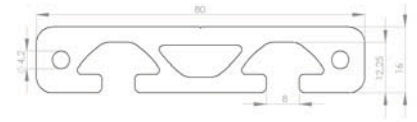

Nut 8

Profil 32X18

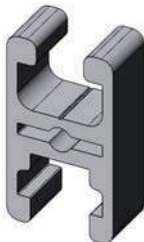

Artikel Nr.:	15002
Ix	2,50 cm ⁴
Iy	2,50 cm ⁴
Wx	1,70 cm ³
Wy	1,70 cm ³
Profilfläche	3,30 cm ²
Masse	0,90 kg/m

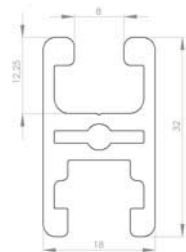

Nut 8

Profil 40X16

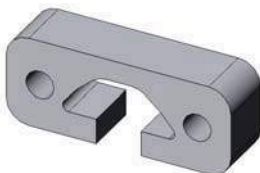

Artikel Nr.:	022230
Ix	1,05 cm ⁴
Iy	6,89 cm ⁴
Wx	1,22 cm ³
Wy	3,45 cm ³
Profilfläche	4,24 cm ²
Masse	1,12 kg/m

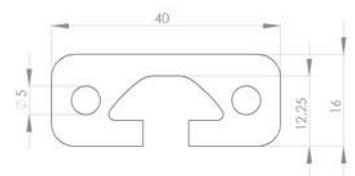

Nut 8

Profil 40X16L

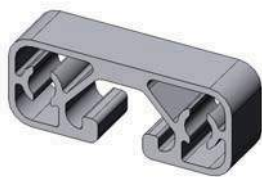

Artikel Nr.:	12180
Ix	0,64 cm ⁴
Iy	3,34 cm ⁴
Wx	0,78 cm ³
Wy	1,67 cm ³
Profilfläche	2,24 cm ²
Masse	0,60 kg/m

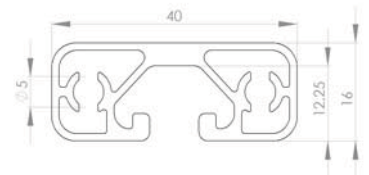

Nut 8

Profil 80X80

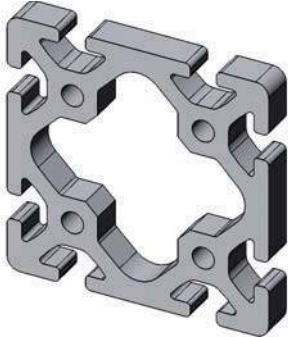

Artikel Nr.:	021226
Ix	187,70 cm ⁴
Iy	187,70 cm ⁴
Wx	46,92 cm ³
Wy	46,92 cm ³
Profilfläche	26,66 cm ²
Masse	7,19 kg/m

Nut 8

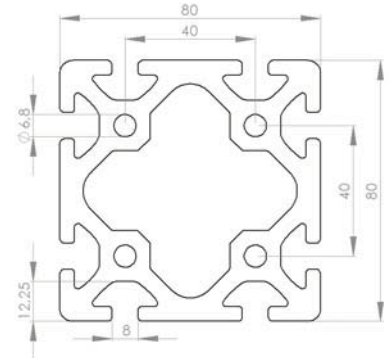

Profil 80x160



Artikel Nr.:	12017
Ix	360,89 cm ⁴
Iy	1.228,33 cm ⁴
Wx	90,22 cm ³
Wy	153,54 cm ³
Profilfläche	50,07 cm ²
Masse	13,52 kg/m

Nut 8

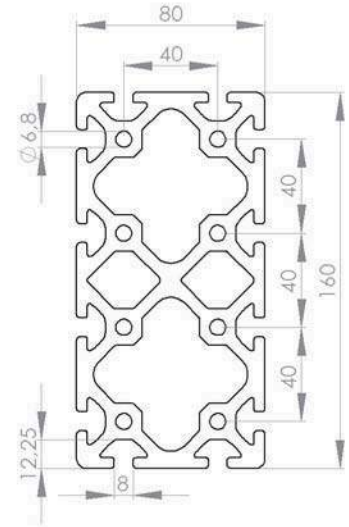

Profil 160X16



Artikel Nr.:	12764
Ix	3,80 cm ⁴
Iy	307,83 cm ⁴
Wx	4,25 cm ³
Wy	38,48 cm ³
Profilfläche	13,88 cm ²
Masse	3,75 kg/m

Nut 8

